

Vibratory Hammer Specifications

ECCENTRIC MOMENT	1,500 IN-LBS
DYNAMIC FORCE	55 TONS
FREQUENCY, MAINTAINED	1,600 VPM
AMPLITUDE	.875 IN
MAX. RATED LINE PULL	30 TONS
HOSE BUNDLE LENGTH	110 FT
SUSPENDED WEIGHT	8,400 LBS
EXCITER WEIGHT WITHOUT CLAMP	5,800 LBS
TRANSPORT WEIGHT W/ 50T CLAMP AND SHIPPING STAND	10,200 LBS
SHIPPING DIMENSIONS - L x W x H	72 x 87 x 89 IN
50T CLAMP WEIGHT	1,100 LBS

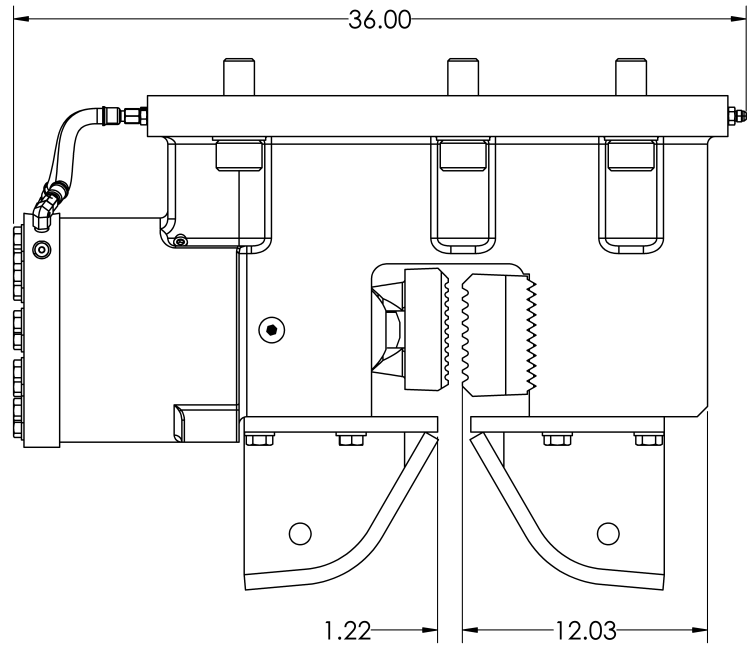
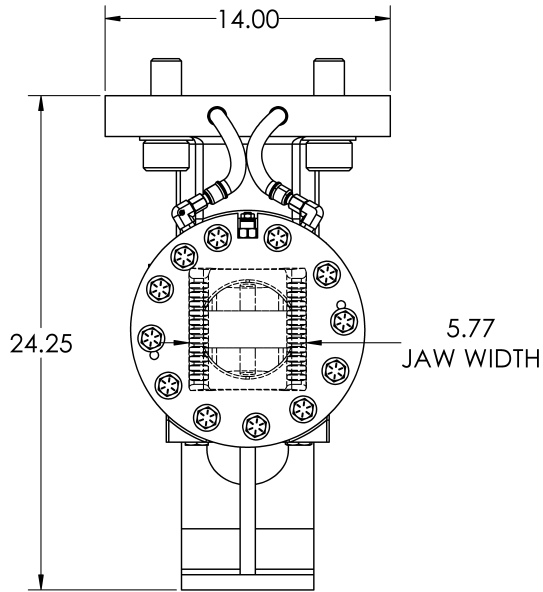

50 Ton Clamp Specifications

CLAMP STYLE	UNIVERSAL CLAMP
CLAMPING FORCE	50 TONS
MAX JAW OPENING	1.63 INCHES
50T CLAMP WEIGHT	1,100 LBS

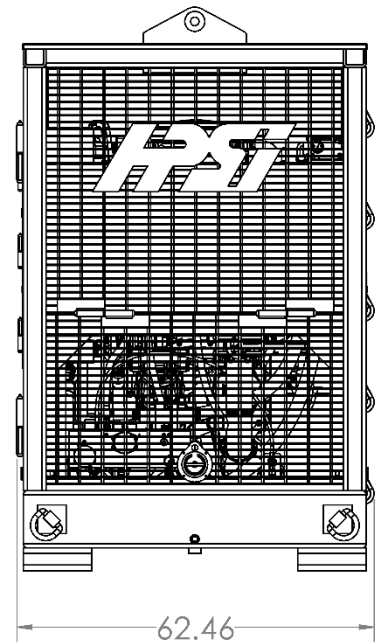
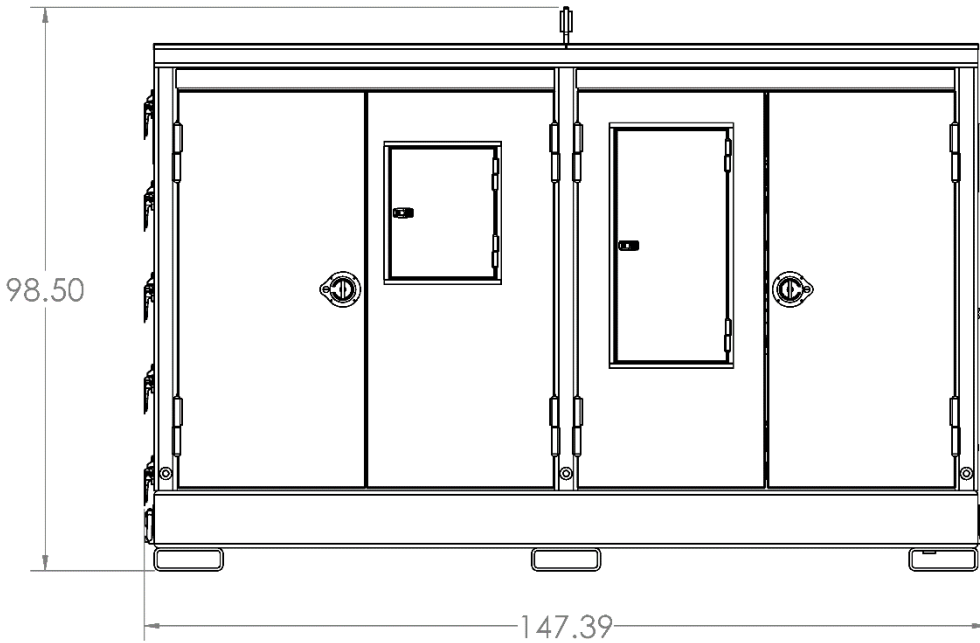

150 Power Pack Specifications

ENGINE	CATERPILLER C7.1
EMISSIONS TIER	TIER 4 FINAL
RATED POWER	275 HP
SPEED	2,200 RPM
HYDRAULIC FLOW	120 GPM
HYDRAULIC DRIVE PRESSURE	2,500 PSI
HYDRAULIC OIL CAPACITY	200 GAL
DIESEL FUEL CAPACITY	86 GAL
REMOTE CONTROL PENDANT	50 FT
WEIGHT	12,800 LBS